



Lexmark XC9200 Series



When you need to go beyond typical page sizes, average print speeds and ordinary service intervals, Lexmark's versatile, multi-format color MFP family supports demanding workloads with a powerful combination of printing, copying, scanning and faxing, plus optional finishing. And they do it all with the combined advantages of Lexmark's sophisticated product thinking and integrated portfolio of features and services.

Sized for success

With its extensive standard features, ability to handle multiple paper formats, and variety of available speeds and configurations, the Lexmark XC9200 series is ideal for medium to large workgroups that need a flexible MFP that can do it all. Its high-impact SRA3/12x18 color output and high-volume capacity also complement the capabilities of existing A4/letter fleets.



Up to 65 ppm



SRA3/12x18



Solutions



Duplex ADF single-pass



10-inch touch screen



Finishing options

Speed with endurance to match

When isn't speed a priority? You need it whether you're printing, scanning, copying or running productivity apps. The XC9200 series builds on speed with thoughtful engineering that drives endurance and minimizes interruptions to keep the work moving.

Speed matters: After delivering a first page as fast as 4.9 seconds, the XC9200 series can reach up to 65 pages per minute or sides per minute (A4/letter)*, depending on model.

Rapid scanning: All models scan up to 160 sides per minute for outstanding capture velocity. Support for mixed originals, page-level jam recovery, standard OCR and a "classify and route" option fulfill the highest-speed automated scanning requirements.

Maximum volume: Meet demanding output needs with maximum monthly duty cycles ranging from 150,000 to 275,000 pages**, depending on model.

*Print and copy speeds measured in accordance with ISO/IEC 24734 and ISO/IEC 24735 respectively (ESAT). For more information see: www.lexmark.com/ISOspeeds.

***"Maximum Monthly Duty Cycle" is defined as the maximum number of pages a device could deliver in a month using a multishift operation. This metric provides a comparison of robustness in relation to other Lexmark printers and MFPs.

Color laser multifunction product

Paper capacity: Configured for high volume, a maximum input capacity of 6,650 sheets handles the largest workloads, while output scales to a massive 3,500.

Toner for the long run: Replacement cartridges print up to 30,000 monochrome or color pages*.

Long-life service intervals: Fusers and developer units produce up to 720,000 and 600,000 pages**, respectively, for impressive uptime.

Intelligent and accessible

What makes an MFP both seamless and efficient to use is responsiveness, an intuitive interface, productivity-enhancing apps, and well-planned accessibility features. And the XC9200 series has them all.

Power for performance: It starts with a 1.2 GHz Quad Core processor and 2 GB of memory (expandable to 4 GB) for both a responsive user interface and exceptional imaging speed.

Bright and easy: A bright, next-generation 10-inch touch screen with Lexmark's own e-Task interface creates an icon- and text-driven experience that's always intuitive to navigate and can walk you through each step. A convenient USB port is right up front for easy document printing and file transfer.

Solutions and more: Enhance your user experience and productivity with the included solution apps, and customize your device via optional apps tailored to your specific need or industry. With available software development kits, you can even create apps of your own.

Hard disk enhancement: The XC9200 series' standard hard disk enables efficiency-boosting features like job buffering while enhancing functions like collating and overall system responsiveness.

Accessibility: There's integrated voice guidance, a standard headphone jack, tiltable control panel, and the ability to use both standard accessibility "swipe" gestures and an optional USB keyboard. It's all part of making Lexmark's best SRA3/12x18-in MFPs ever not just accessible to those with varying levels of abilities, but a better user experience for everyone.

Standard OCR and advanced routing options

Every Lexmark XC9200 series device includes built-in optical character recognition (OCR) software capable of turning printed characters on a scanned page into searchable text. Save the file to a thumb drive, email it to anyone, or send it to a network share for further processing or integration with software you supply and manage. Beyond basic OCR, Lexmark's optional AccuRead Automate software enables any XC9200 model to capture, automatically classify and route documents, while extracting key information for file naming and indexing. There's no need for an additional server—AccuRead Automate does it all right on the device, eliminating manual data entry errors and expediting business processes.

*Yield at approximately 5% print coverage per color.

**Actual Yield may vary based on other factors such as device speed, paper size and feed orientation, toner coverage, tray source, percentage of black-only printing and average print job complexity.



Equipped for professional output

Show your colors, enhance your output with finishing, and connect the power of the XC9200 series to any network environment.

Pro color: Match your most critical colors and present your boldest ideas with a well-stocked color toolbox that includes PANTONE® calibration, embedded color sample pages and Lexmark Color Replacement for easy matching of spot and RGB colors.

Advanced finishing: Boost your in-house production capabilities and reach new customers with optional finishing like multi-position stapling, hole punch, booklet, saddle stitch and tri-fold.

Connected to your world: Gigabit Ethernet ports ensure connectivity to all modern networks, while dual USB 2.0 high-speed rear ports can interface to individual devices. Optional wireless and fiber optic cards further expand your circle of authorized users.

The Lexmark advantage

The XC9200 series bring fast, high-capacity, professional-color performance in a larger format to even the most challenging settings. And they do it all with the combined advantages of Lexmark's sophisticated product thinking and our integrated portfolio of features and services.

Security: Lexmark's comprehensive full-spectrum security is built into all our products to create not just a safer but a more productive environment. Our portfolio of security covers secure access, document and network security, secure remote management, hard disk security and optional features like secure print release. Together, they reflect our experience working in some of the most highly regulated, mission-critical settings on earth.

Mobility: Make mobile printing as easy as PC printing with the free Lexmark Mobile Print app, or get output via AirPrint®, Google Cloud Print™, Mopria® or Windows® Mobile on networks with wireless access. Adding the XC9200 series' optional wireless card enables direct printing, so you can bypass the network. More mobile printing options means more choices for you and your users.

Manageability: XC9200 series MFPs become an integrated part of an existing managed Lexmark fleet as soon as you plug them in, thanks to full compatibility with free, downloadable Markvision Enterprise software. With MVE, you can track, troubleshoot and update devices throughout their lifecycle—from the moment they join the network until the day you retire them.



Security and more

Advanced security features: Lexmark XC9200 security features encompass device management, hardening and operation.

Device management: A combination of administrative access and passwords, HTTPS, SNMPv3, IPsec and 802.1x support lets you remotely monitor, manage, authorize and authenticate who and what gets access to the network.

Device hardening: Built-in tools include port filtering and TCP connection filtering which restrict what connections are active from which sources. Encrypting and wiping the hard disk protects sensitive print job data. Digitally signed firmware updates prevent hackers from uploading compromised software to the MFP.

Device operation: You get user authentication via PIN, passwords or badge reader, address book lookup via LDAP over SSL (Secure Socket Layer) to provide a secure connection between the MFP and the network, and device operator panel lockouts to protect the device settings.

Hard disk protection: The hard disk is protected with 256-bit AES encryption and encryption keys stored in the MFP's memory, not the hard disk. The data is protected even if the hard drive is removed. This level of protection is automatic at power up—users and administrators don't have to do anything.

The XC9200 series also performs automatic file-based hard disk wiping after every print job, which cannot be disabled. And the process of clearing a device's disk drive and non-volatile memory data when removing it from service or a secure location is simple with a one-step "out of service" wiping command for authorized users.

Built for planet earth

Power saving modes: Sleep mode sips less than 3 watts to save money and energy between print jobs. When the device is not in use, it goes to sleep and quickly wakes for incoming print jobs. In addition, it can be manually powered on or off from its control panel or automatically via a user-defined schedule. And low power-mode sensors wake the MFP when paper is placed in the ADF or the scanner lid is opened.

Paper and toner savings: Standard duplex mode prints on both sides of each sheet by default, without slowing down, for complete duplex efficiency at the device's rated print speed. Plus, the unique ColorSaver feature prints images at a lighter shade by default, while leaving text dark and readable, saving toner and money.

And the included Eco-Copy solution lets you print copies of scanned items using predefined settings like duplex, pages per sheet and copies per sheet to further save paper.

Recycled paper compatibility: To ensure that you can minimize the impact of paper you use, the Lexmark XC9200 Series has been fully tested with a range of recycled papers, up to 100% recycled.

Environmental certifications: These Lexmark products meet globally recognized environmental standards*:

- ▶ ENERGY STAR®
- ▶ Blue Angel
- ▶ EPEAT® Silver
- ▶ RoHS Compliant

*ENERGY STAR V2.0 for Imaging Equipment (EU RoHS and Section 4.3.1.1 of IEEE 1680.2-2).

1. Intuitive color touch screen with next-generation e-Task interface

The large 10-inch color touch screen features an ultra-smooth surface and can be activated by almost anything, including pens, fingertips or nails—without pressure or direct skin contact. The modern interface is familiar to users, minimizing the need for training.

2. Speedy scanner

Duplex automatic document feeder holds 100 sheets and supports scanning at up to 160 sides per minute for outstanding capture velocity. Support for mixed originals, page-level jam recovery, standard OCR and a “classify and route” option fulfill the highest-speed automated scanning requirements.

3. Expandable input

Print on multiple paper types and sizes, with input capacity up to 6,650 sheets.

4. Finishing options

Expand your capabilities with finishing options that include multi-position stapling, hole punch, booklet, saddle stitch and tri-fold. The finisher raises output capacity to 3,500 sheets.

5. High-capacity production yields

Genuine Lexmark toner cartridges print up to 30,000 monochrome or color pages*, while fusers and developer units produce up to 720,000 and 600,000** pages, respectively, for impressive uptime.

6. Software solutions

Enhance your user experience and productivity with the included solution apps, and customize your device via optional apps tailored to your specific need or industry. With available software development kits, you can even create apps of your own. Lexmark smart MFP adaptability helps future-proof your investment.

7. Direct printing

Print Microsoft Office files, PDFs and other document and image types from flash drives, or select and print documents from network servers or online drives.



*Yield at approximately 5% print coverage per color.

**Actual Yield may vary based on other factors such as device speed, paper size and feed orientation, toner coverage, tray source, percentage of black-only printing and average print job complexity.

Lexmark XC9200 Series features

Product specifications	Lexmark XC9235	Lexmark XC9245	Lexmark XC9255	Lexmark XC9265
Printing				
Display	Lexmark e-Task 10-inch class color touch screen			
Print Speed: Up to ⁵	Black: 35 ppm / Color: 35 ppm	Black: 45 ppm / Color: 45 ppm	Black: 55 ppm / Color: 55 ppm	Black: 65 ppm / Color: 65 ppm
Time to First Page: As fast as	Black: 6.8 seconds / Color: 6.8 seconds	Black: 5.1 seconds / Color: 5.1 seconds	Black: 5 seconds / Color: 5 seconds	Black: 4.9 seconds / Color: 4.9 seconds
Print Resolution	Black: 1200 x 1200 dpi, 2400 Image Quality / Color: 1200 x 1200 dpi, 2400 Image Quality			
Memory	Standard: 2048 MB / Maximum: 4096 MB			
Hard Disk	Included in configuration			
Recommended Monthly Page Volume ²	4000 - 20000 pages	6000 - 50000 pages	7000 - 50000 pages	8000 - 50000 pages
Maximum Monthly Duty Cycle: Up to ³	200000 pages per month	225000 pages per month	250000 pages per month	275000 pages per month
Copying				
Copy Speed: Up to ⁵	Black: 35 cpm / Color: 35 cpm	Black: 45 cpm / Color: 45 cpm	Black: 55 cpm / Color: 55 cpm	Black: 65 cpm / Color: 65 cpm
Time to First Copy: As fast as	Black: 6.6 seconds / Color: 7.9 seconds	Black: 4.9 seconds / Color: 5.8 seconds		Black: 4.8 seconds / Color: 5.5 seconds
Scanning				
Scanner Type / ADF Scan	Flatbed scanner with ADF / DADF (single pass Duplex)			
A4/Ltr Duplex Scan Speed: Up to	Black: 160 / 160 sides per minute / Color: 160 / 160 sides per minute			
A4/Ltr Simplex Scan Speed: Up to	Black: 80 / 80 sides per minute / Color: 80 / 80 sides per minute			
Faxing				
Modem Speed	ITU T.30, V.34 Half-Duplex, 33.6 Kbps			
Supplies ⁷				
Laser Cartridge Yields (up to) ¹	30,000-page Black and Colour (CMYK) Cartridges			
Photoconductor Estimated Yield: Up to ⁶	100000 Black / 90000 (CMY) pages, based on 3 average letter/A4-size pages per print job and ~ 5% coverage			
Developer Unit(s) Estimated Yield: Up to ⁶	600000 pages, based on 3 average letter/A4-size pages per print job and ~ 5% coverage			
Cartridge(s) Shipping with Product ⁸	6,000-page Colour (CMY) Toner Cartridges, 5,000-page Black Toner Cartridge	18,500-page Black Toner Cartridge, 11,500-page Colour (CMY) Toner Cartridges		
Paper Handling				
Included Paper Handling	Integrated Duplex, 250-Sheet Output Bin, 150-Sheet Multipurpose Feeder, 2 x 500-Sheet Input			
Optional Paper Handling	Staple Finisher, Staple Punch Finisher, 2500-Sheet Tandem Tray, 3000-Sheet Tray, Booklet Finisher, 2 x 500-Sheet Tray			Staple Finisher, Staple Punch Finisher, 3000-Sheet Tray, Booklet Finisher, 2 x 500-Sheet Tray
Paper Input Capacity: Up to	Standard: 1150 pages 20 lb or 75 gsm bond / Maximum: 6650 pages 20 lb or 75 gsm bond			
Paper Output Capacity: Up to	Standard: 250 pages 20 lb or 75 gsm bond / Maximum: 3500 pages 20 lb or 75 gsm bond			
Media Types Supported	Card Stock, Envelopes, Labels, Plain Paper, Vinyl Labels, Refer to the Card Stock & Label Guide., Banner Paper			
Media Sizes Supported	10 Envelope, 7 3/4 Envelope, 9 Envelope, A3, A4, A5, B5 Envelope, C5 Envelope, DL Envelope, Executive, Folio, JIS-B5, Legal, Letter, Statement, Universal, Super Tabloid (12 x 18"), Oficio, A6, SRA3			
General Information ⁴				
Standard Ports	One Internal Card Slot, USB 2.0 Specification Hi-Speed Certified (Type B), Gigabit Ethernet (10/100/1000), Two Rear USB 2.0 Specification Hi-Speed Certified ports (Type A), Two Front USB 2.0 Specification Hi-Speed Certified port (Type A)			
Optional Network Ports / Optional Local Ports	Internal MarkNet N8360 802.11b/g/n Wireless, NFC, MarkNet N8230 Fiber Ethernet Print Server / External RS-232C serial, Internal 1284-B Bidirectional Parallel			
Noise Level: Operating	Print: 51 dBA / Copy: 55 dBA / Scan: 53 dBA	Print: 52 dBA / Copy: 56 dBA / Scan: 53 dBA		Print: 55 dBA / Copy: 57 dBA / Scan: 53 dBA
Specified Operating Environment	Altitude: 0 - 2500 Meters (8,200 Feet), Humidity: 15 to 85% Relative Humidity, Temperature: 10 to 30°C (50 to 86°F)			
Size (in. - H x W x D) / Weight (lb.)	36.3 x 24.2 x 27.4 in. / 239.2 lb.			48.2 x 24.2 x 27.4 in. / 296.5 lb.

¹Average yield at approximately 5% print coverage per colour. ²"Recommended Monthly Page Volume" is a range of pages that helps customers evaluate Lexmark's product offerings based on the average number of pages customers plan to print on the device each month. Lexmark recommends that the number of pages per month be within the stated range for optimum device performance, based on factors including: supplies replacement intervals, paper loading intervals, speed, and typical customer usage.

³"Maximum Monthly Duty Cycle" is defined as the maximum number of pages a device could deliver in a month using a multishift operation. This metric provides a comparison of robustness in relation to other Lexmark printers and MFPs. ⁴Printers are sold subject to certain license/agreement conditions. See www.lexmark.com/printerlicense for details.

⁵Print and copy speeds measured in accordance with ISO/IEC 24734 and ISO/IEC 24735 respectively (ESAT). For more information see: www.lexmark.com/ISOspeeds. ⁶Actual Yield may vary based on other factors such as device speed, paper size and feed orientation, toner coverage, tray source, percentage of black-only printing and average print job complexity. ⁷Product functions only with replacement cartridges designed for use in a specific geographical region. See www.lexmark.com/regions for more details. ⁸ Average continuous black or continuous composite CMY declared cartridge yield up to this number of standard pages in accordance with ISO/IEC 19798.

This is a Class A device according to the FCC Rules and international electromagnetic emissions standards. This device is not intended for use in residential or domestic environments due to potential interference to radio communications.

Lexmark XC9200 Series features

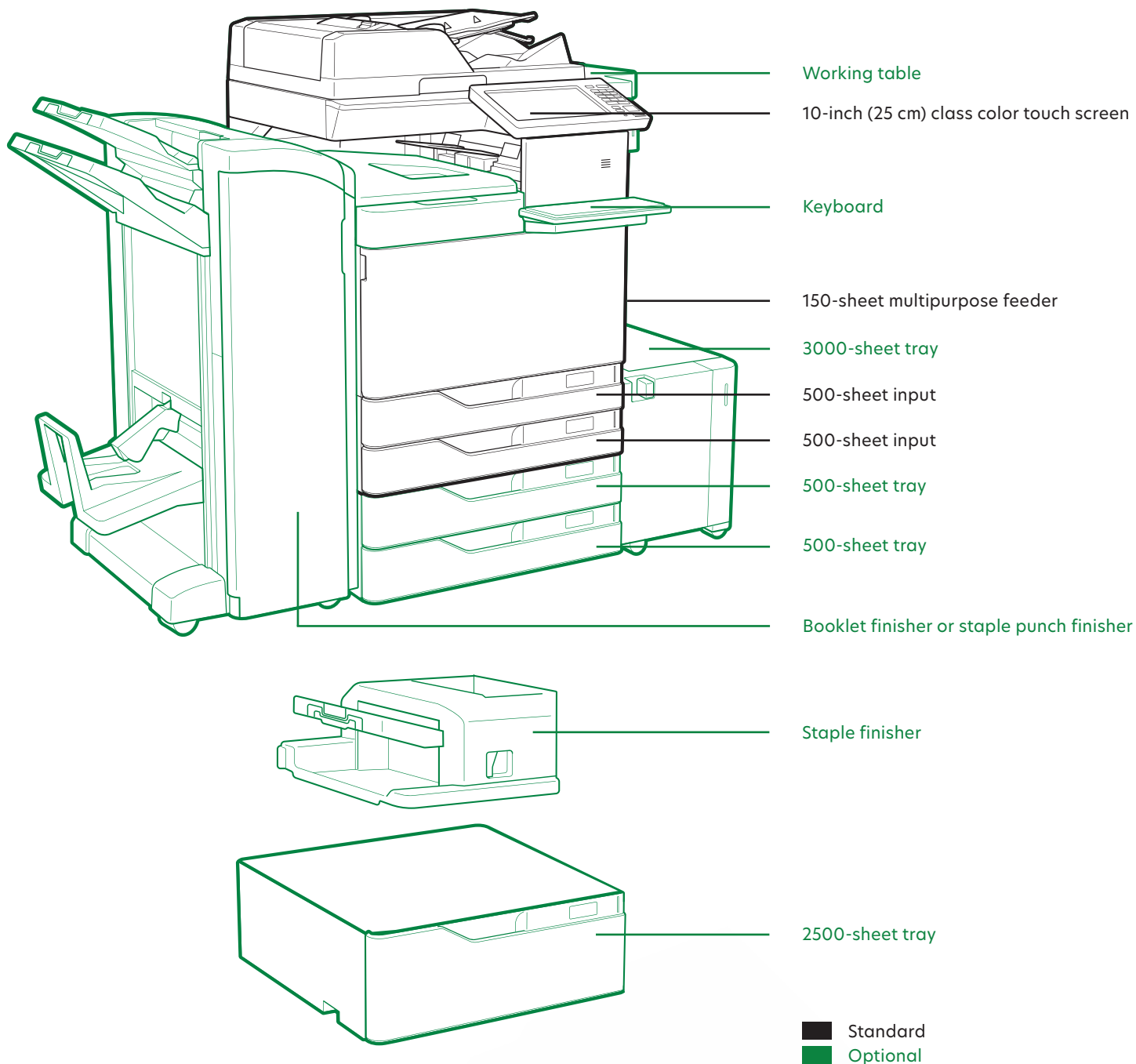

© 2017 Lexmark and the Lexmark logo are trademarks or registered trademarks of Lexmark International, Inc. in the United States and/or other countries. All other trademarks are the property of their respective owners.

AirPrint® and the AirPrint Logo® are trademarks of Apple, Inc.

ENERGY STAR® is a U.S. registered mark.

EPEAT® is a trademark of EPEAT, Inc. in the United States and other countries.

Google Cloud Print™ is a trademark of Google, Inc.

MOPRIA®, the Mopria® Logo™ and the Mopria® Alliance logos are trademarks, service marks, and certification marks of Mopria Alliance, Inc. in the United States and other countries.

Notice: "This product includes software developed by the OpenSSL Project for use in the Open SSL Toolkit (<http://www.openssl.org/>)."